

# Hub / Gateway

Quickstart Guide



# **ATTENTION**

**Please setup and register this device FIRST!**

**In order to receive alerts, the Skyhawk Hub must be used in conjunction with a Skyhawk Sensor (sold separately) and the Skyhawk CE smartphone app.**

**See the specific Skyhawk Sensor user's manual for additional information on connecting your devices.**

Need to download the **Skyhawk CE App?**



# Table of Contents

Device Overview .....	4
Status Lights .....	5 - 6
Activate Hub .....	7 - 8
Start-Up Operation .....	9
Shutdown Operation .....	10
Resetting Hub .....	11
Battery Replacement .....	12
Product Support .....	17
FCC Information .....	18

# Device Overview

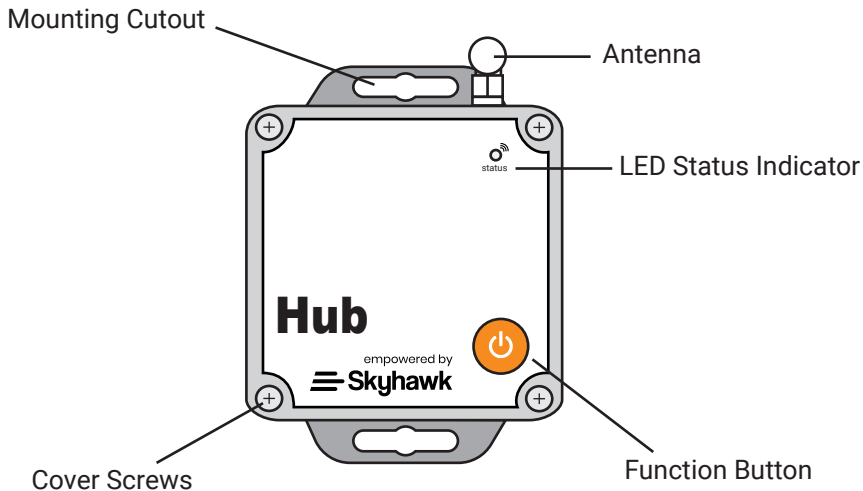

# Device Status Lights

Powering Up



Powering Down



RF Event Trigger



Device Reset



Firmware update



\*Success Indicator, Solid LED

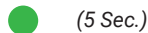

\*Failure Indicator, Solid LED



Blink



Rapid Flashing



Pause

# Device Status Lights

While unit is ON and not being triggered the status LED will flash every 5 seconds:

Last transmission was successful



*(Rapid flash once)*

Last transmission failed



*(Rapid flash once)*

Unit currently paused



*(Rapid flash once)*

# Activate Hub

1

Open Skyhawk CE App

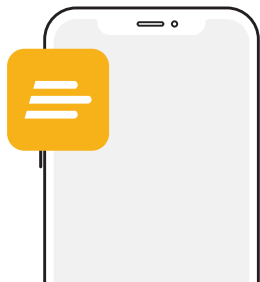

2

Open Main Menu

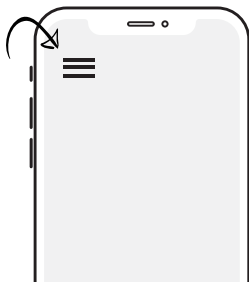

3

Select Add Device

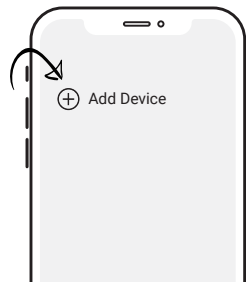



## Activate Hub

Scan the unique QR code located on the back of the device and follow all in-app instructions to finish activating your Hub.

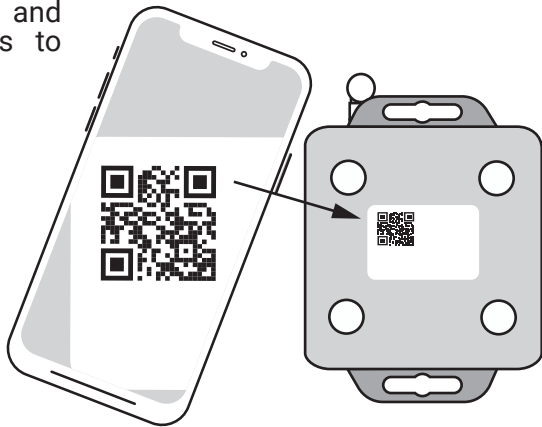

# Start-Up Operation

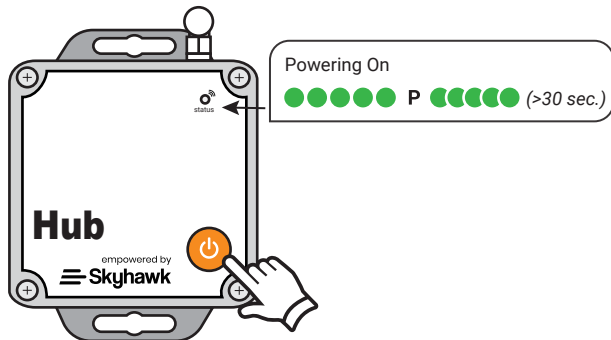

- 1.) Power ON the Hub by pressing and holding the function button; release when the GREEN status LED starts blinking.
- 2.) Upon successful completion of the power ON process an alert will be sent to the Skyhawk CE application.

# Shutdown Operation

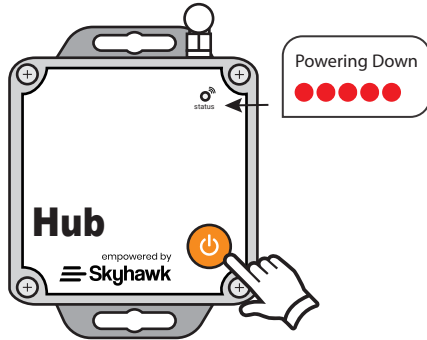

- 1.) Power OFF the Hub by pressing and holding the function button; release when the RED status LED starts blinking.
- 2.) Upon successful completion of the power OFF process an alert will be sent to the Skyhawk CE application.

# Resetting Hub

*(Factory Default Setting)*

1

**Press & Hold  
Function Button**



2

**Keep Holding  
Function Button**



status

Press and hold button  
until LED sequence changes  
to rapid blinking red

3

**Release  
Function Button**



status

4

**Startup Operation  
Begins**



status

# Battery Replacement

**IMPORTANT:** Always replace batteries with 3 new and identical name-brand AA lithium batteries.

1

Unscrew/Open  
Hub Case



2

Remove Batteries

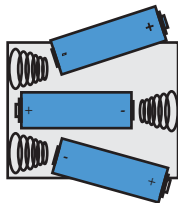

3

Insert New Batteries  
(Following +/- symbols)

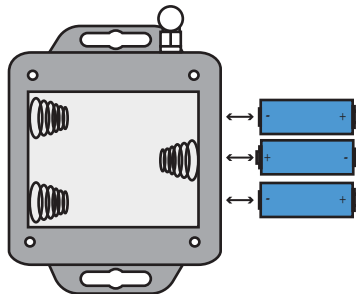

4

Close Case > Startup  
Sequence Begins



## **Product Support & Manuals**

For product support and to download detailed user and product manuals:

**[support.sky-hawk.com](http://support.sky-hawk.com)**

## **FCC Information**

This device complies with part 15 of the FCC Rules. Operation is subject to the following two conditions:

(1) This device may not cause harmful interference, and (2) this device must accept any interference received, including interference that may cause undesired operation.



App Store and the Apple logo are trademarks of Apple Inc. | Google Play and the Google Play logo are trademarks of Google LLC.

Skyhawk™, No Wi-Fi. No Power. No Problem.™, Skyhawk CE™ and Skyhawk Logo are trademarks of PICA Product Development, LLC, dba Skyhawk. ©2021 All rights reserved.

Rev A1 - 7/21